

**APPLICATION FOR A MODIFICATION ORDER**

**WILDLIFE AND COUNTRYSIDE ACT, 1981**

**The Wildlife and Countryside (Definitive Maps and Statements) Regulations, 1983 (Schedule 7)**

DEFINITIVE MAP AND STATEMENT FOR THE PARISH OF Haverigg

DISTRICT OF Milcom PUBLIC RIGHT OF WAY NO. \_\_\_\_\_

TO: THE HEAD OF LEGAL SERVICES, CUMBRIA COUNTY COUNCIL

OF: THE COURTS, CARLISLE, CUMBRIA, CA3 8LZ

I/We (Name of applicant) FRANCIS EDWARD ROBERTS

Of (Address of applicant) 18 POOLSIDE

HAVERIGG

MILCOM

CUMBRIA

hereby apply for an Order under Section 53(2) of the Wildlife and Countryside Act 1981 modifying the Definitive Map and Statements for the area by

1 ~~Deleting the \*(footpath) (bridleway) (restricted byway) (byway open to traffic)~~

From:

To:

2 Adding the ~~\*(footpath) (bridleway) (restricted byway) (byway open to traffic)~~

From: Grid reference 34.16249.78717

To: (formerly "Concrete Square")

3 ~~\*(Upgrading) (downgrading) to a \*(footpath) (bridleway) (restricted byway) (byway open to all traffic) the \*(footpath) (bridleway) (restricted byway) (byway open to all traffic)~~

From:

To:

4 ~~\*(Varying) (adding to) the particulars relating to the \*(footpath) (bridleway) (restricted byway) (byway open to all traffic)~~

From:

To:

By providing that

and shown on the map annexed hereto.

\* Please delete as appropriate

I/We attach copies of the following documentary evidence (including statements of witnesses) in support of this application:

List of Documents provided

*Maps and evidence forms supplied 8th Jan. 2008.  
Further evidence forms to follow shortly.*

Date .....

Signed .....

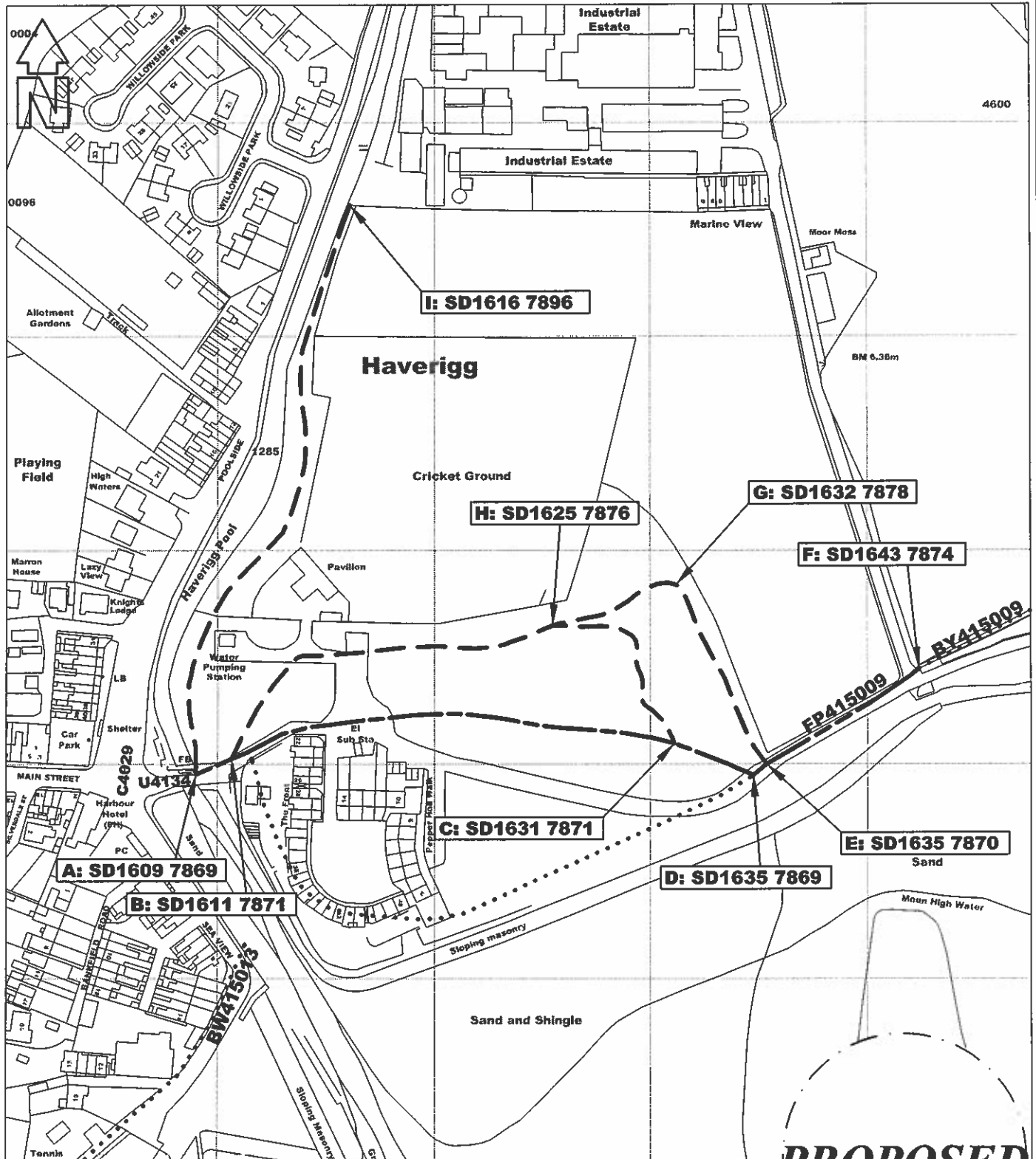

**Wildlife and Countryside Act, The Cumbria County Council  
Parish of Millom  
PUBLIC PATH MODIFICATION ORDER  
No.1, 2008: DISTRICT OF COPELAND**

**PROPOSED**  
S E A L

Head of Legal Services

**KEY**

Footpath to be Added	-----
Bridleway to be Added	=====
Footpath to be Upgraded to Bridleway	-----
Route to Remain	.....

H:\Parish Files\Copeland\Millom\415000\  
415000-Legal Orders\415000-M2-001-Am1-Order Plan  
Extract from OS Map Nos SD1678 & 1679  
Reproduced or based upon, Ordnance Survey map material with the  
permission of the controller of Her Majesty's Stationery Office, Crown  
Copyright LA 076546 - Cumbria County Council. Unauthorised reproduction  
infringes Crown Copyright and may lead to prosecution or civil proceedings

Scale 1:2500



