

APPLICATION FOR A MODIFICATION ORDERWILDLIFE AND COUNTRYSIDE ACT, 1981The Wildlife and Countryside (Definitive Maps and Statements) Regulations, 1983 (Schedule 7)DEFINITIVE MAP AND STATEMENT FOR THE PARISH OF LOWER ALLITHWAITEDISTRICT OF CARTMEL PUBLIC RIGHT OF WAY NO.

TO: THE HEAD OF LEGAL SERVICES, CUMBRIA COUNTY COUNCIL

OF: THE COURTS, CARLISLE, CUMBRIA, CA3 8LZ

I/We (Name of applicant) DAVID UNSWORTH & SUSAN GILLOf (Address of applicant) 2 THE FLAGS CORNBRIDGE URM AND
CARTMEL CHASSE R BECK
LALL 6PN CARTMEL LALL 6PN

hereby apply for an Order under Section 53(2) of the Wildlife and Countryside Act 1981 modifying the Definitive Map and Statements for the area by

- 1 ~~Deleting the *(footpath) (bridleway) (restricted byway) (byway open to traffic)~~

From:

To:

- 2 Adding the *(footpath) (bridleway) (restricted byway) (byway open to traffic)

From: FORD ROAD CARTMELTo: PENNY BRIDGE CARTMEL

- 3 *(Upgrading) (downgrading) to a *(footpath) (bridleway) (restricted byway) (byway open to all traffic) the *(footpath) (bridleway) (restricted byway) (byway open to all traffic)

From:

To:

- 4 *(Varying) (adding to) the particulars relating to the *(footpath) (bridleway) (restricted byway) (byway open to all traffic)

From:

To:

By providing that

and shown on the map annexed hereto.

* Please delete as appropriate

I/We attach copies of the following documentary evidence (including statements of witnesses) in support of this application:

List of Documents provided

16 - WCA & FORMS.

PHOTO SHOWING FOOTPATH on 12/5/2000.

PHOTO SHOWING FOOTPATH on 18/11/2007 showing
gate blocking entry & path overgrown.

Date 18/11/07

Signed

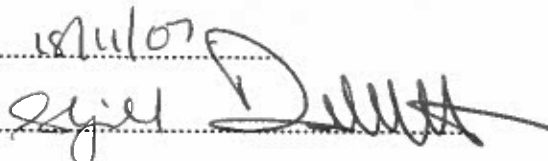

Land Registry
Current title plan

Title number CU192428
Ordnance Survey map reference SD3778NE
Scale 1:1250
Administrative area CUMBRIA: SOUTH
LAKELAND

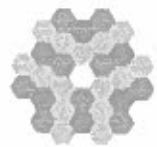

© Crown Copyright. Produced by Land Registry. Reproduction in whole or in part is prohibited without the prior written permission of Ordnance Survey. Licence Number 100026316.

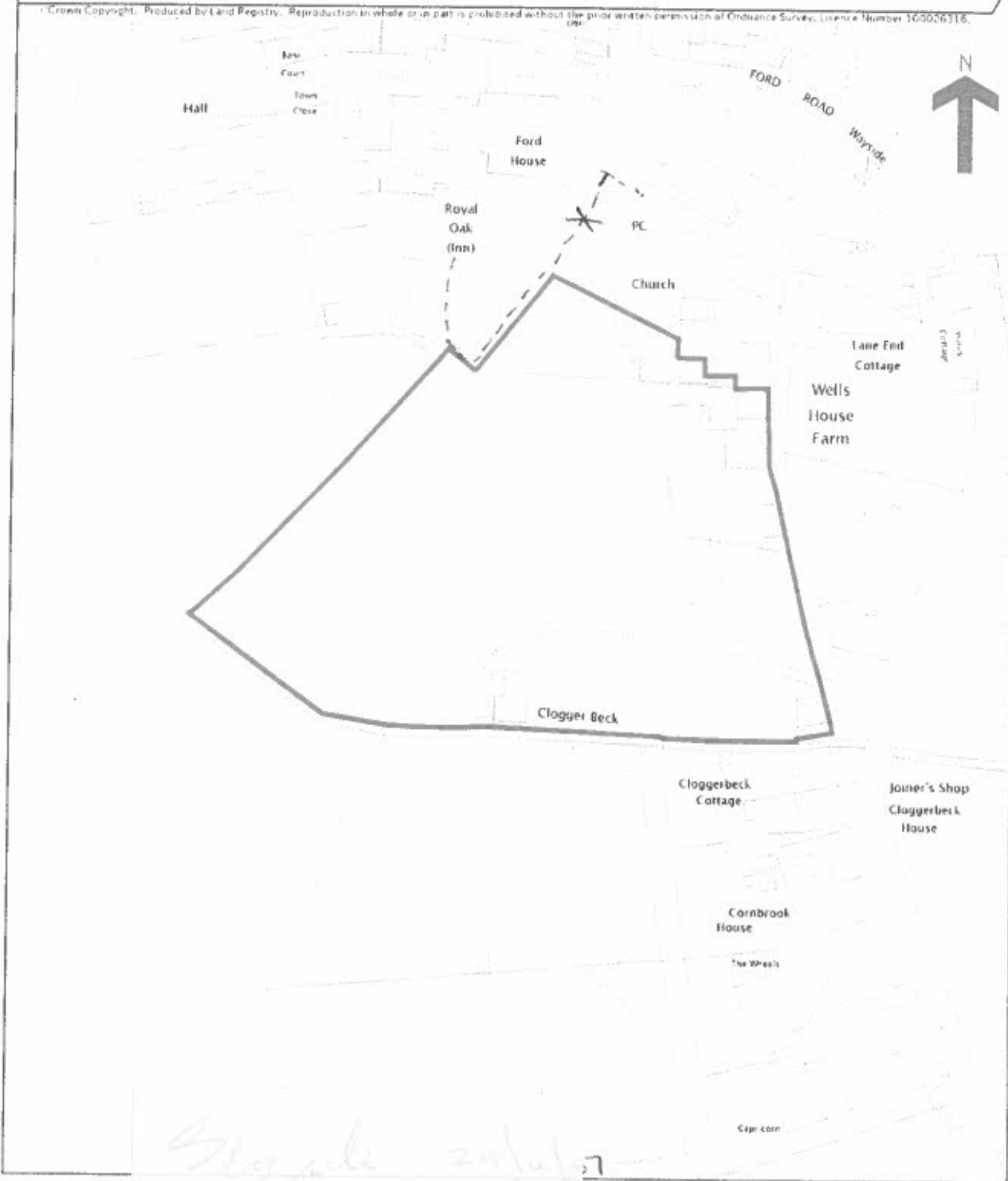

Styde 24/1/07
South Lakeland
IV.07

This is a copy of
it still pending in
This copy is not a
extent as the origi
If you want to obt
The Land Registry
depend on your p
boundaries. It m
points on the gro

This title is dealt with by LAND REGISTRY, DISTRICT (BOROUGH) OFFICE.

it take account of any application made after that time even

plan is admissible in evidence in a court to the same
he suffers loss by reason of a mistake in an official copy.
to do this.

the plan images. The quality and accuracy of any print will
ows the general position, not the exact line, of the
in this plan may not match measurements between the same

