

APPLICATION FOR A MODIFICATION ORDER

WILDLIFE AND COUNTRYSIDE ACT, 1981

The Wildlife and Countryside (Definitive Maps and Statements) Regulations, 1983 (Schedule 7)

DEFINITIVE MAP AND STATEMENT FOR THE PARISH OF GRANGE-OVER-SANDS

DISTRICT OF SOUTH LAKE AND PUBLIC RIGHT OF WAY NO. —

TO: CUMBRIA COUNTY COUNCIL

OF: COUNTRYSIDE ACCESS, THE LONSDALE BUILDING, THE COURTS,
CARLISLE, CUMBRIA, CA3 8NA

I/We (Name of applicant) ELISABETH FELL

Of (Address of applicant) 7 TEMPLAND PARK

ALLTHWAITE

GRANGE-OVER-SANDS

LAI 7QS

hereby apply for an Order under Section 53(2) of the Wildlife and Countryside Act 1981 modifying the Definitive Map and Statements for the area by

1 ~~Deleting the *(footpath) (bridleway) (restricted byway) (byway open to traffic)~~

From:

To:

2 Adding the *(footpath) (bridleway) (restricted byway) (byway open to traffic)

From: US668 CART LANE SD 4021 7677

To: THE PROMENADE SD 4040 7697

3 ~~*(Upgrading) (downgrading) to a *(footpath) (bridleway) (restricted byway) (byway open to all traffic) the *(footpath) (bridleway) (restricted byway) (byway open to all traffic)~~

From:

To:

4 ~~*(Varying) (adding to) the particulars relating to the *(footpath) (bridleway) (restricted byway) (byway open to all traffic)~~

From:

To:

and shown on the map attached.

* Please delete as appropriate

~~I~~We attach copies of the following documentary evidence (including statements of witnesses) in support of this application: + CD

List of Documents provided

See attached pages

Date 9 February 2012

Signed Christine Fell

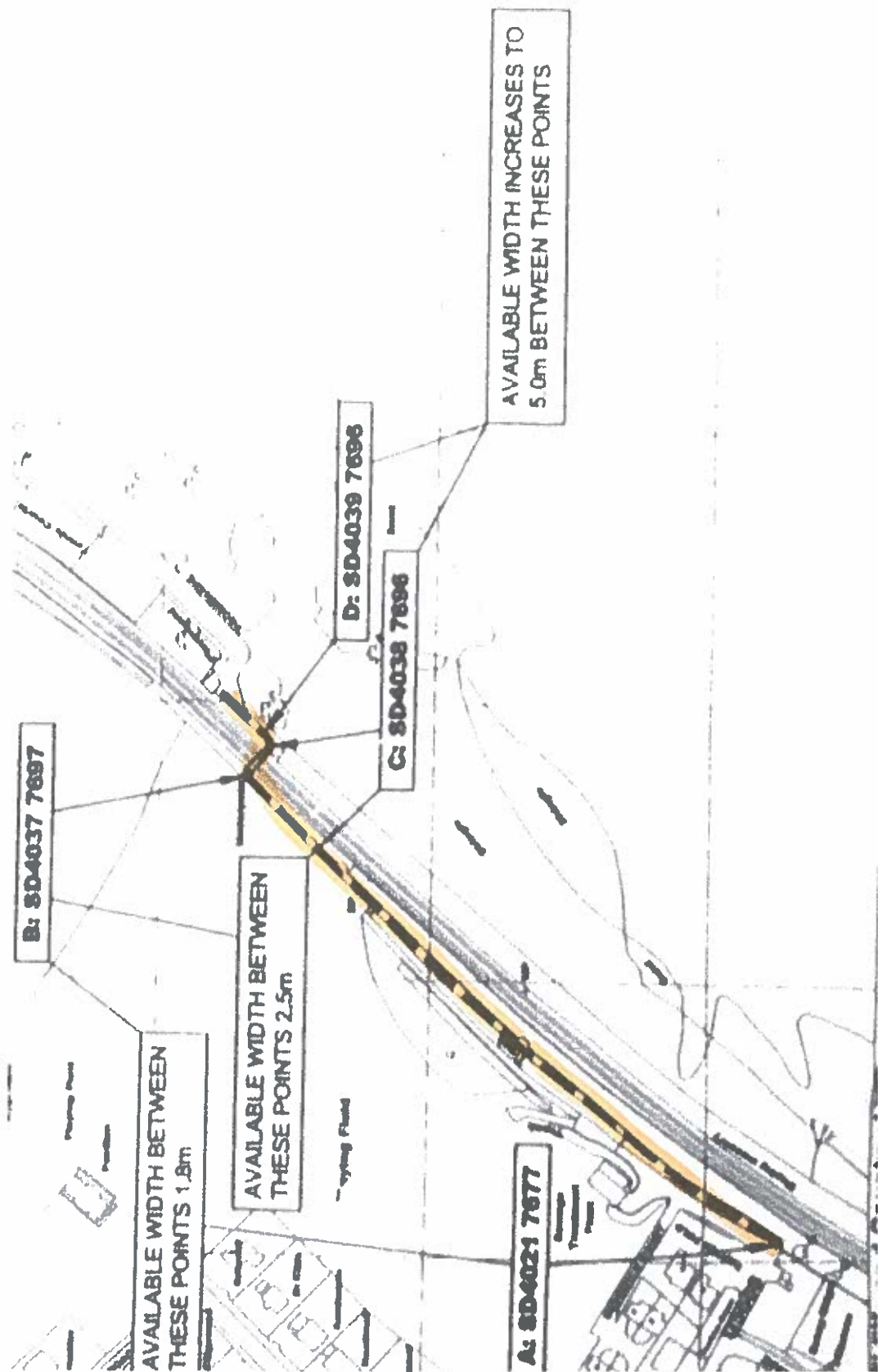

CART LANE / PLAYING FIELDS SUBWAY / PROMENADE

APPLICATION FOR A MODIFICATION ORDER**WILDLIFE AND COUNTRYSIDE ACT, 1981****The Wildlife and Countryside (Definitive Maps and Statements) Regulations, 1983 (Schedule 7)**DEFINITIVE MAP AND STATEMENT FOR THE PARISH OF GRANGE-OVER-SANDSDISTRICT OF SOUTH LAKE LAND PUBLIC RIGHT OF WAY NO. —

TO: CUMBRIA COUNTY COUNCIL

OF: COUNTRYSIDE ACCESS, THE LONSDALE BUILDING, THE COURTS,
CARLISLE, CUMBRIA, CA3 8NAI/We (Name of applicant) ELISABETH FELLOf (Address of applicant) 7 TEMPLAND PARKALLITHWAITEGRANGE-OVER-SANDSLAI 7QShereby apply for an Order under Section 53(2) of the Wildlife and Countryside Act 1981
modifying the Definitive Map and Statements for the area by~~1 Deleting the *(footpath) (bridleway) (restricted byway) (byway open to traffic)~~

From:

To:

2 Adding the *(footpath) (bridleway) (restricted byway) (byway open to traffic)

From: 85277 LINDALE ROAD SD 4123 7820UNDER THE SUBWAYTo: THE PROMENADE SD 4123 7814~~3 *(Upgrading) (downgrading) to a *(footpath) (bridleway) (restricted byway) (byway open to all traffic) the *(footpath) (bridleway) (restricted byway) (byway open to all traffic)~~

From:

To:

~~4 *(Varying) (adding to) the particulars relating to the *(footpath) (bridleway) (restricted byway) (byway open to all traffic)~~

From:

To:

and shown on the map attached.

* Please delete as appropriate

I/We attach copies of the following documentary evidence (including statements of witnesses) in support of this application:

List of Documents provided

See list attached to WCA 5 for CART LANE

Date 9 February 2012

Signed Christine Bell

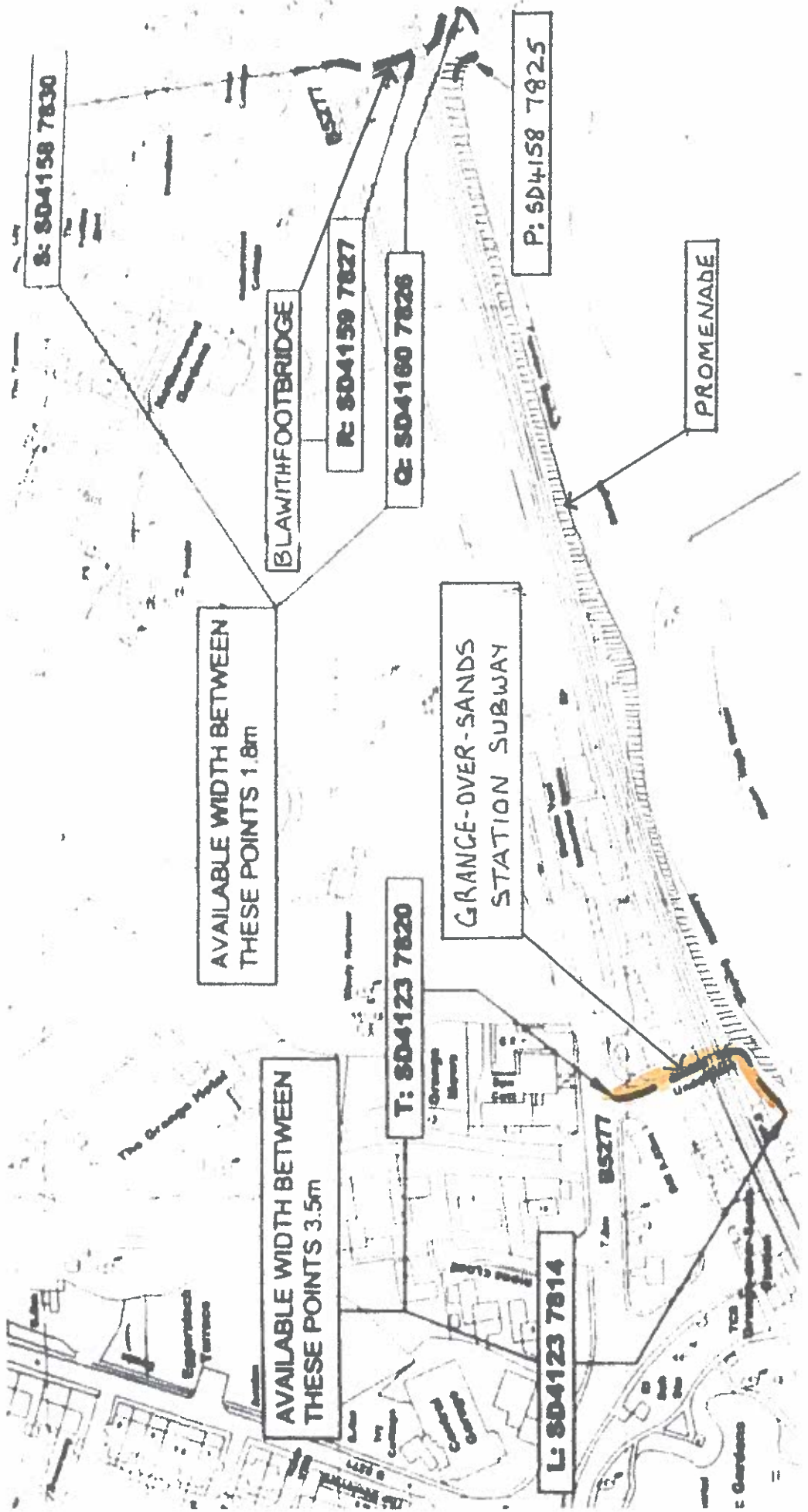

S: SD4158 7830

BLAWITH FOOTBRIDGE

R: SD4159 7827

Q: SD4160 7826

P: SD4158 7825

PROMENADE

AVAILABLE WIDTH BETWEEN THESE POINTS 1.8m

GRANGE-OVER-SANDS STATION SUBWAY

T: SD4123 7820

AVAILABLE WIDTH BETWEEN THESE POINTS 3.5m

L: SD4123 7814

GRANGE STATION SUBWAY

APPLICATION FOR A MODIFICATION ORDERWILDLIFE AND COUNTRYSIDE ACT, 1981The Wildlife and Countryside (Definitive Maps and Statements)
Regulations, 1983 (Schedule 7)DEFINITIVE MAP AND STATEMENT FOR THE PARISH OF GRANGE-OVER-SANDSDISTRICT OF SOUTH LAKELAND PUBLIC RIGHT OF WAY NO.

TO: CUMBRIA COUNTY COUNCIL

OF: COUNTRYSIDE ACCESS, THE LONSDALE BUILDING, THE COURTS,
CARLISLE, CUMBRIA, CA3 8NAI/We (Name of applicant) ELISABETH FELLOf (Address of applicant) 7 TEMPLAND PARKALWITHWAITEGRANGE-OVER-SANDSLA11 7QShereby apply for an Order under Section 53(2) of the Wildlife and Countryside Act 1981
modifying the Definitive Map and Statements for the area by~~1 Deleting the *(footpath) (bridleway) (restricted byway) (byway open to traffic)~~

From:

To:

2 Adding the *(footpath) (bridleway) (restricted byway) (byway open to traffic)

From: B5277 LINDALE ROAD SD4158 7830To: OVER BLAWITH BRIDGE
THE PROMENADE SD4158 7825~~3 *(Upgrading) (downgrading) to a *(footpath) (bridleway) (restricted byway) (byway
open to all traffic) the *(footpath) (bridleway) (restricted byway) (byway open to all
traffic)~~

From:

To:

~~4 *(Varying) (adding to) the particulars relating to the *(footpath) (bridleway) (restricted
byway) (byway open to all traffic)~~

From:

To:

and shown on the map attached.

* Please delete as appropriate

I/We attach copies of the following documentary evidence (including statements of witnesses) in support of this application:

List of Documents provided

Separate ~~list~~ list attached to WCA 5 for CART LANE

Date 9 February 2012

Signed Elizabeth Fell

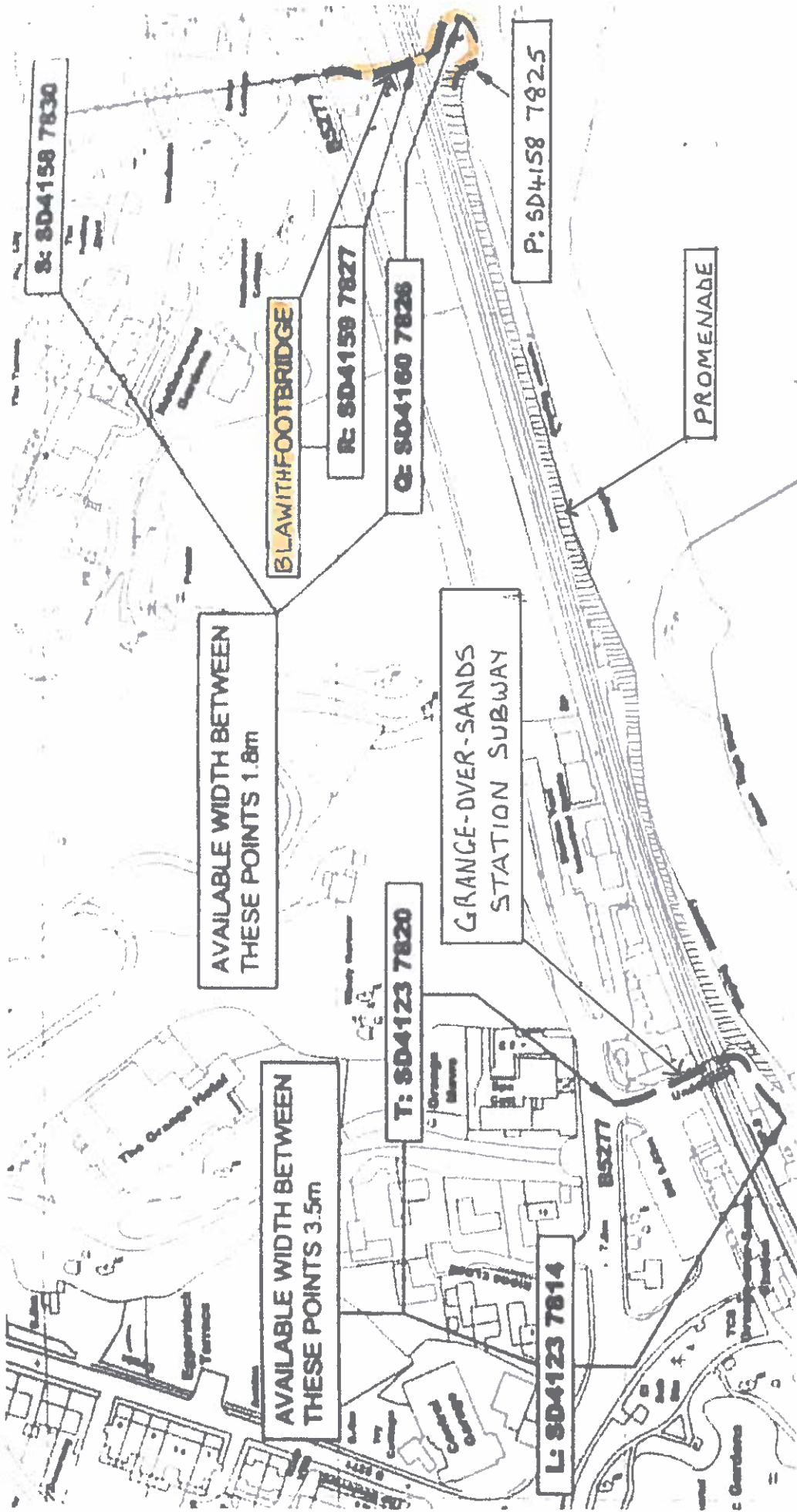

BLAWITH FOOTBRIDGE

