

**STATUTORY DECLARATION**  
**Section 31(6) of the Highways Act 1980**

I, Robert James Roskell, a Director of Fleetwood Building Company Ltd ("hereinafter called "the company") of 54 Caunce Street, Blackpool DO SOLEMNLY AND SINCERELY DECLARE as follows:

1. I am the Director of Fleetwood Building Company and am authorised by the Company to make this declaration.
2. The Company is and has been since March 1969 the owner of the land known as land at Vicarage Drive and more particularly delineated on the map accompanying this declaration and thereon edged red.
3. On the 23<sup>rd</sup> day of October 2009 the company deposited with Cumbria County Council, being the appropriate Council, a statement accompanied by a map delineating the Company's property by pink colouring which stated that no ways had been dedicated as highways over the Company's property.
4. No additional ways have been dedicated over the land edged red on the map accompanying this declaration since the statement dated 23<sup>rd</sup> October 2009 referred to in 3. above and at the present time the Company has no intention of dedicating any more public rights of way over its property.

AND I MAKE this solemn declaration on the 23<sup>rd</sup> day of October, 2009 conscientiously believing it to be true and by virtue of the Statutory Declarations Act 1835.

Declared at

*Skipton North Yorkshire*

Signed:

*R. Roskell*

Before me

*Wm. Charles Wood & Bro  
Solicitors*

**CHARLESWORTH WOOD & BROS**  
SOLICITORS  
23 OTLEY STREET  
SKIPTON  
NORTH YORKSHIRE BD23 1D

Land Registry  
Official copy of  
title plan

Title number CU229516  
Ordnance Survey map reference SD5191NW  
Scale 1:1250  
Administrative area Cumbria: South Lakeland

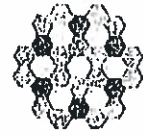

© Crown Copyright. Produced by Land Registry. Reproduction in whole or in part is prohibited without the prior written permission of Ordnance Survey. Licence Number 100028316

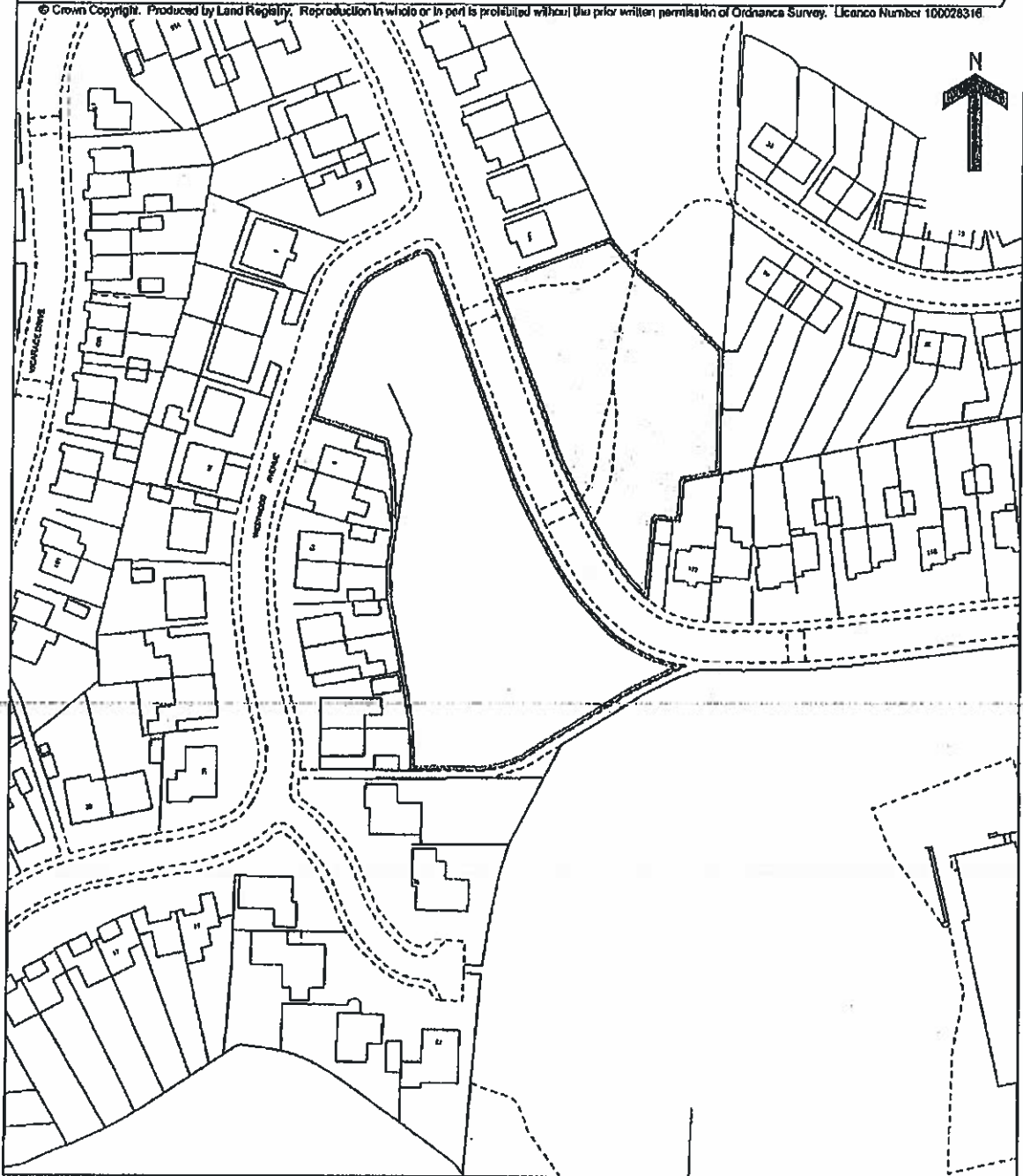

This official copy issued on 17 July 2007 shows the state of this title plan on 17 July 2007 at 10:27:56. It is admissible in evidence to the same extent as the original (s.67 Land Registration Act 2002).

This title plan shows the general position, not the exact line, of the boundaries. It may be subject to distortions in scale. Measurements scaled from this plan may not match measurements between the same points on the ground. See Land Registry Public Guide 7 - Title Plans.

This title is dealt with by Land Registry, Durham (Boldon) Office.

536044 +