

STATUTORY DECLARATION

HIGHWAYS ACT 1980 SECTION 31 (6)

I AVERIL HAROLD DO SOLEMNLY AND SINCERELY DECLARE as follows:

1. The Woodland Trust, a company limited by guarantee and registered charity no. 294344, is and has been since 22 March 1991 the owner of the land known as The Glen, Heads Nook more particularly delineated on the plan accompanying this declaration and thereon edged red.
2. On the 27 January 2003 the Woodland Trust deposited with Cumbria County Council, being the appropriate Council, a statutory declaration stating that no additional ways [other than those marked in the appropriate colour on the plan accompanying this declaration] had been dedicated as footpaths since the deposit of the statement 19 June 1991.
3. No additional ways have been dedicated over the land edged red on the plan accompanying this declaration since the statutory declaration referred to in 2 above [other than those footpaths marked in the appropriate colour on the plan accompanying this declaration] and at the present time the Woodland Trust has no intention of dedicating any more public rights of way over its property.

AND I MAKE this solemn declaration on the 7th day of December, 2012 conscientiously believing it to be true and by virtue of the Statutory Declarations Act 1835.

Declared at: The Woodland Trust, Kempton Way, Grantham, Lincolnshire, NG31 6LL

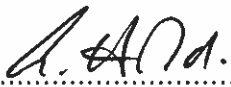



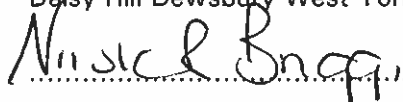

.....

Averil Harold (Mrs)
Legal Officer authorised to sign on behalf of the Woodland Trust

Before me, Nicola Briggs, Solicitor, of Messrs Hellewell Pasley & Brewer 66/68 Daisy Hill Dewsbury West Yorkshire WF13 1LS

.....

Statutory Declaration Legend

-  Woodland Trust Boundary
-  Footpath
-  Bridleway
-  Byway Open to All Traffic
-  Restricted Byway
-  Other legal route

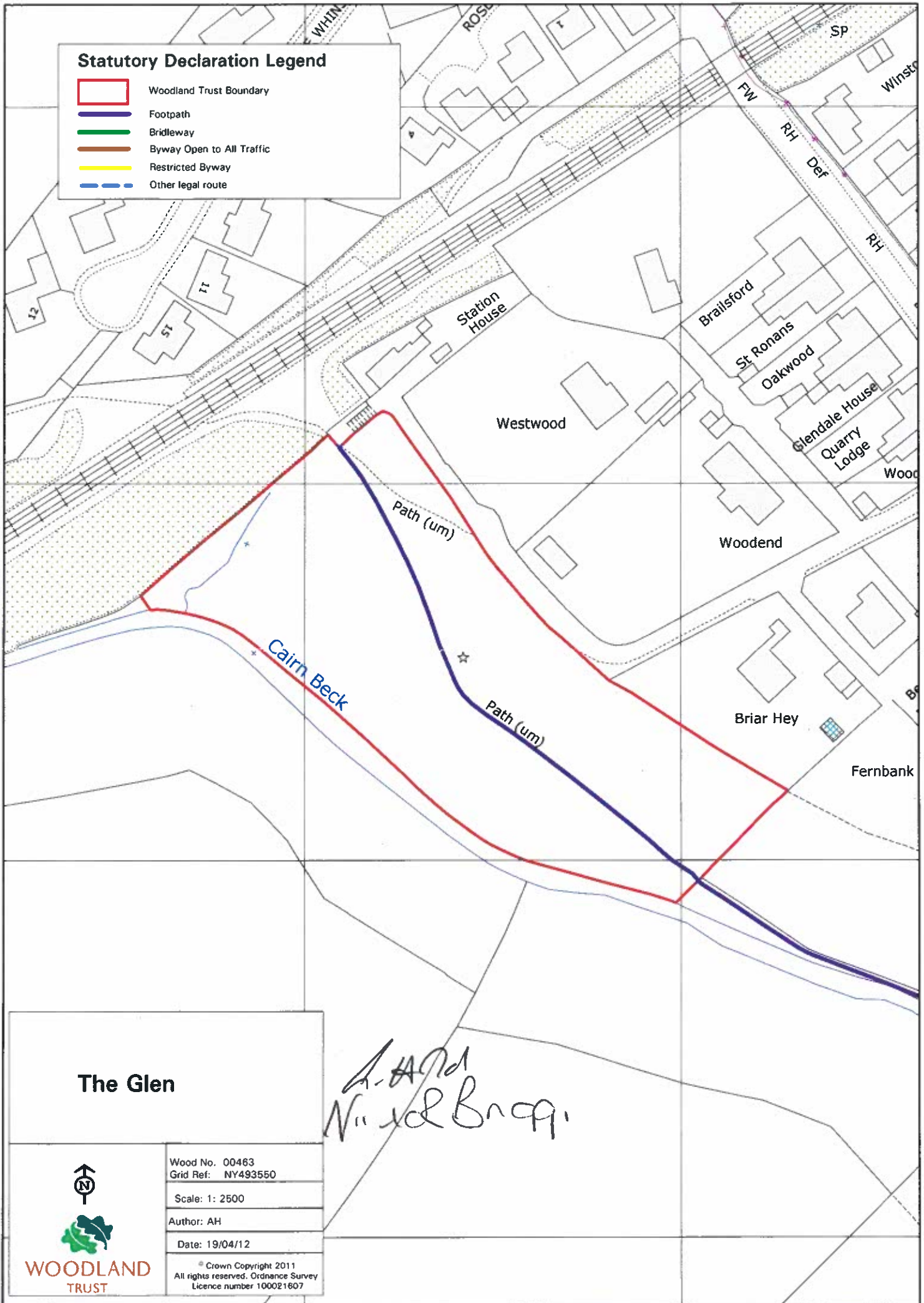

The Glen



WOODLAND TRUST

Wood No. 00463
Grid Ref: NY493550

Scale: 1: 2500

Author: AH

Date: 19/04/12

© Crown Copyright 2011
All rights reserved. Ordnance Survey
Licence number 100021607

A. AND N. and B. 1991